



butterfly valve  
connection  
pressure  
preferred flow direction  
available sizes  
pressure classes

flanged - lug style valve P.O. Box 681986, Houston, TX 77268-1986  
automation options are available  
3" - 40", other sizes on request  
ANSI 150, 300, 600



with special materials -454°F to +1472°F

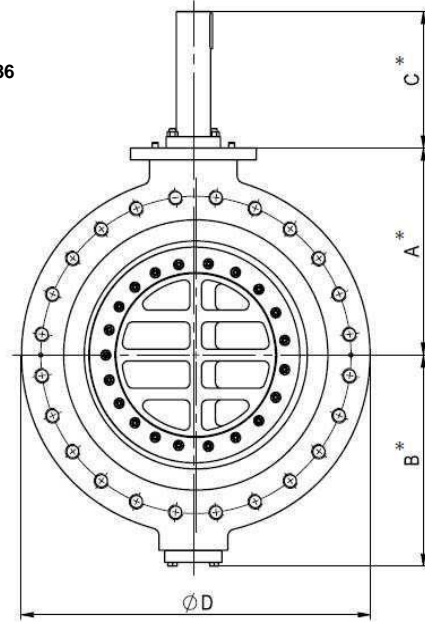
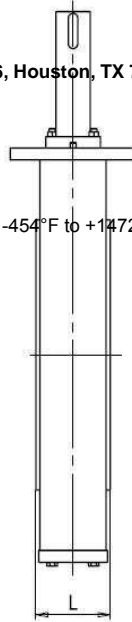

### specification

body materials	carbon steel, stainless steel, special materials (duplex, Inconel, bronze, or other)
function	on/off or modulating
pressure range	body pressure up to ANSI class 600
	Trim A - shaft design for maximum $\Delta p$ in both directions of 290 psi, for <b>Class 150</b>
	Trim X (std) - shaft design for maximum $\Delta p$ in both directions of 754 psi, for <b>Class 300</b> (or Class 150)
	Trim B - shaft design for maximum $\Delta p$ in both directions of 1500 psi, for <b>Class 600</b>
leak rate	API-6D, API-598 Resilient, 1 DIN 3230 A DIN EN 12266, BS 6364
	bi-directional with preferred direction indicated on valve
process temperatures	standard +14°F to +642°F <b>Quadax Valves, Inc.</b>
approvals	PED, Fire Safe API-607 5th Edition, BAM, TA Luft, ATEX, and more

### dimensional data

size	[inch]		3	4	5	6	8	10	12	14	16	18	20	24
pipe cl to mounting plate	A		5.04	6.38	-	7.99	9.45	10.98	12.01	12.80	15.16	15.94	17.32	20.87
pipe cl to cover screws	B		5.08	6.22	-	8.03	9.49	11.06	12.09	13.11	15.08	15.87	17.36	21.30
shaft height from plate	C		3.74	4.92	-	5.71	7.09	7.09	7.09	11.02	11.38	11.81	12.17	12.60
flange diameter	ANSI 150	D	7.48	9.06	-	11.02	13.86	15.94	19.09	21.65	23.23	25.20	27.56	32.09
	ANSI 300	D	8.27	10.00	-	12.60	14.96	17.52	20.28	23.03	25.98	27.95	30.31	35.75
	ANSI 600	D	8.27	10.83	-	13.98	16.54	20.00	22.05	23.82	26.97	29.33	32.09	37.01
API 609 face to face	ANSI 150	L	1.88	2.13	-	2.25	2.50	2.81	3.19	3.63	4.00	4.50	5.00	6.06
	ANSI 300	L	1.88	2.13	-	2.31	2.88	3.25	3.63	4.63	5.25	5.88	6.25	7.13
	ANSI 600	L	2.13	2.52	-	3.06	4.00	4.63	5.50	6.13	7.00	7.88	8.50	9.13

### Cv value

size	[inch]		3	4	5	6	8	10	12	14	16	18	20	24
Cv [gpm]			137	300	486	810	1755	3030	4462	6370	9237	12483	15024	24013
		Trim X $\Delta p$ max 754 psi	137	300	486	760	1680	2850	4326	5953	8513	11612	14091	22387
		Trim C $\Delta p$ max 2250 psi	117	242	400	670	1458	2469	3698	5185	7305	10160	11913	-

This valve's technical design is based on media and application requirements. This can lead to deviations from the general specifications shown on the data sheet with regards to the design, sealing materials, and characteristics. Specifications subject to change.